

Our prices

The rates for the apartment are

- 1-2 guests 48 Euro/night
- 3 guests 66 Euro/night
- 4 guests 80 Euro/night

◇ The prices are inclusive of heating, electricity, end cleaning, linen, towels and dishcloths.

Please note that minimum booking is for 3 nights.

◇ Please also note that there is a one-off surcharge of Euro 6 per person for less than 5 nights occupancy.

◇ Arrival from 2pm (exception on request)

◇ Departure before 10am (exception on request)

Our ***DTV Service

- Food shopping service prior to your arrival available (extra charge)
- Free extra cleaning service after your first week (on request).
- Iron and ironing board
- For cleaning jobs: vacuum cleaner, broom, dustpan and brush
- Weather station
- First Aid Box
- Free internet access (WLAN/WI-FI Hotspot)

So you find us:

By train:

Gundelsheim is located on the railway line Stuttgart - Heilbronn - Bad Friedrichshall - Heidelberg - Mannheim, about halfway between Stuttgart and Heidelberg.

By car:

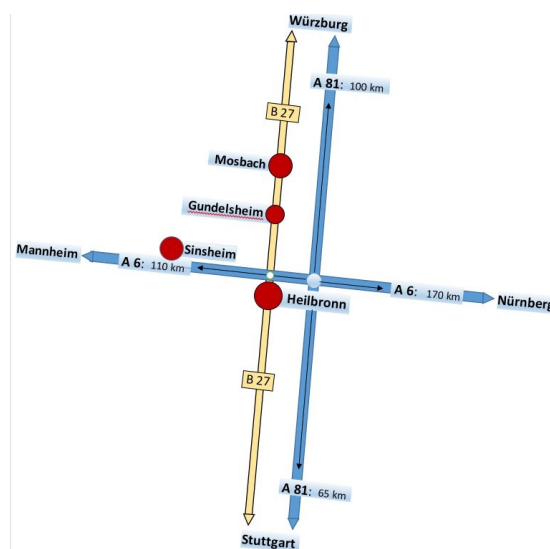

Ferienwohnung Panorama F*** DTV-Klassifizierung

Lindenweg 5, D-74831 Gundelsheim

+49 (0)6269 - 429 816
Mobil: 0176 - 78 73 75 48

E-Mail: ul1ho@gmx.de
www.ferienwohnung-gundelsheim.de

Ferienwohnung Panorama F*** DTV-Klassifizierung



If you are looking for ...

- rest and relaxation
- accomodation as cyclists
- lodging as work engineer

Then this
is the place for you!

Lindenweg 5, D-74831 Gundelsheim

+49 (0)6269 - 429 816
Mobil: 0176 - 78 73 75 48

E-Mail: ul1ho@gmx.de
www.ferienwohnung-gundelsheim.de

Welcome in Gundelsheim

Gundelsheim with its 7,500 inhabitants is located on the Neckar River. It is about 60 km to Heidelberg.



The city's landmark is castle Horneck with the Transylvanian Museum.

Worth a visit is always the historic old town. Many buildings and street names tell a rich story.



Hikers enjoy a well-developed network of trails around Gundelsheim. These lead across fields, through the vineyards or through forests near the city.



Very well known is the "Neckarsteig", on which you can hike to Heidelberg.

Cyclists will find to the city via the Salz- / Sole or the Neckar valley cyclepaths. Both are connected to the Kocher / Jagst and Schefflenz valley cyclepaths.

The ***apartment ...

The apartment for 2-4 guests is located in the first floor of a detached family home in a quiet cul-de-sac.

Away from traffic it is located near the salt cyclepath. It is about 1 km to reach the Neckar valley cyclepath. Well-maintained paths in the vicinity offer excellent opportunities for cycling, hiking and walking in the beautiful nature.



From the balcony you can enjoy magnificent views of the surrounding countryside. From the bedroom and the kitchen windows you see "Castle Horneck", the "Himmelreich" and the "Michaelsberg".



Florplan ...

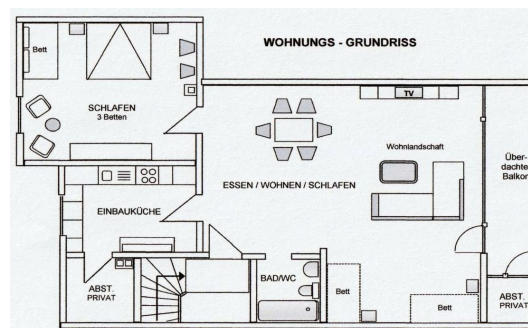

The apartment has a area of 86 sq.m. The largest room is the living / dining room. It is equipped with a sofa bed, a dining table for 6 people, 2 comfortable beds, a satellite TV, a DVD player and a radio.



In the bedroom is a large mirrored wardrobe, a comfortable double bed and a single bed. If necessary, a cot can be added.

The kitchen is equipped with stove, refrigerator, dishwasher, microwave, coffee maker, egg / water cooker and toaster, as well as cutlery and service for up to 6 people.

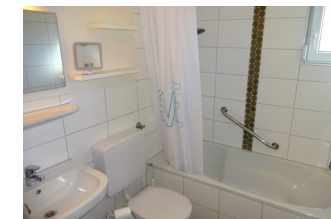

The bathroom is equipped with shower bathtub, sink and toilet.